

- INDEX OF BOUNDARIES
- 37. Taylor Creek Aw
 - 38. Joputul Road
 - 39. Lyons Valley Road
 - 40. Barrett Truck Trail
 - 41. Barrett Lake
 - 42. Pine Valley Creek
 - 43. Interstate 8
 - 44. Sunrise Highway
 - 45. Morris Ranch Road
 - 46. Desert View Road
 - 47. Thing Valley Road
 - 48. Canebrake Wash
 - 49. Anza Borrego Desert State Park Boundary
 - 50. Interstate 6
 - 51. Imperial County Line
 - 52. Mexican Border

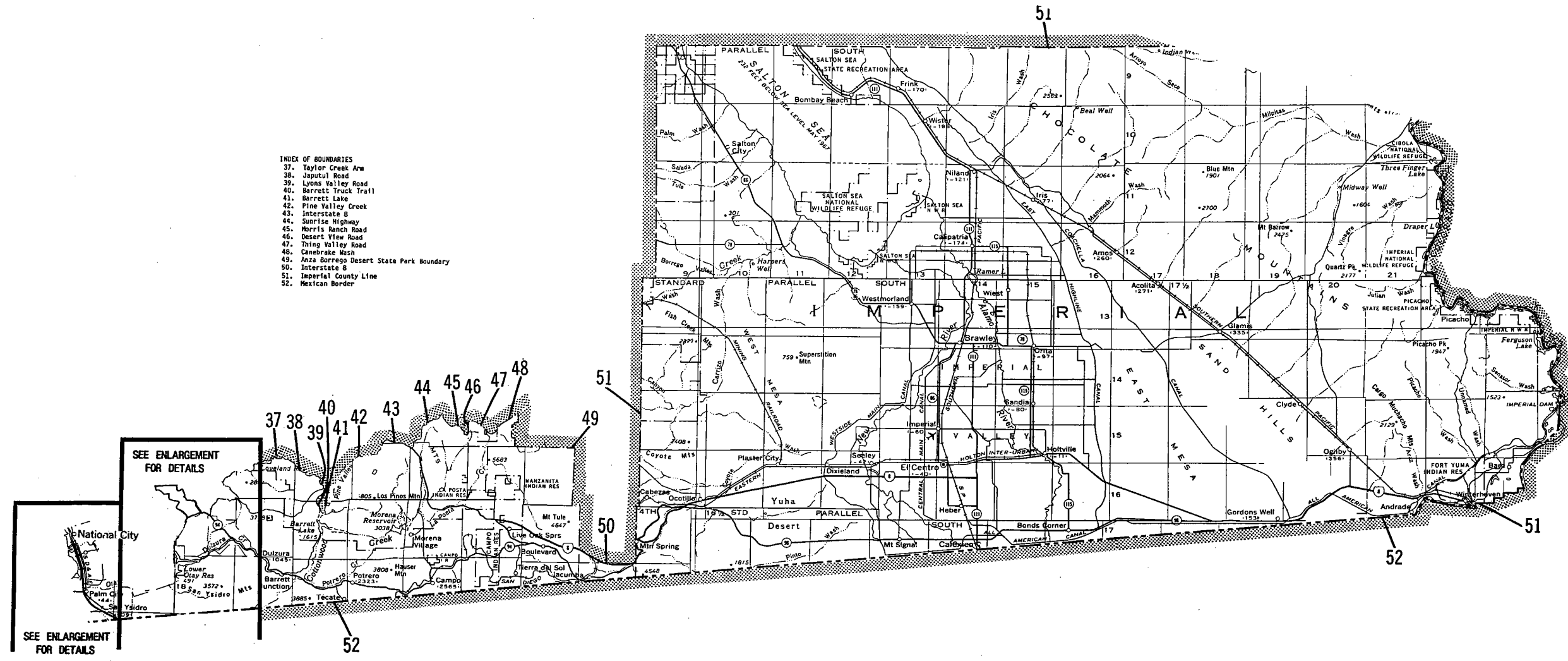

80th ASSEMBLY DISTRICT
 Sheet 1 of 3

CALIFORNIA STATE ASSEMBLY
 1982 REAPPORTIONMENT PLAN

Johan Klehs, Chairman
 Assembly Committee on
 Elections and Reapportionment

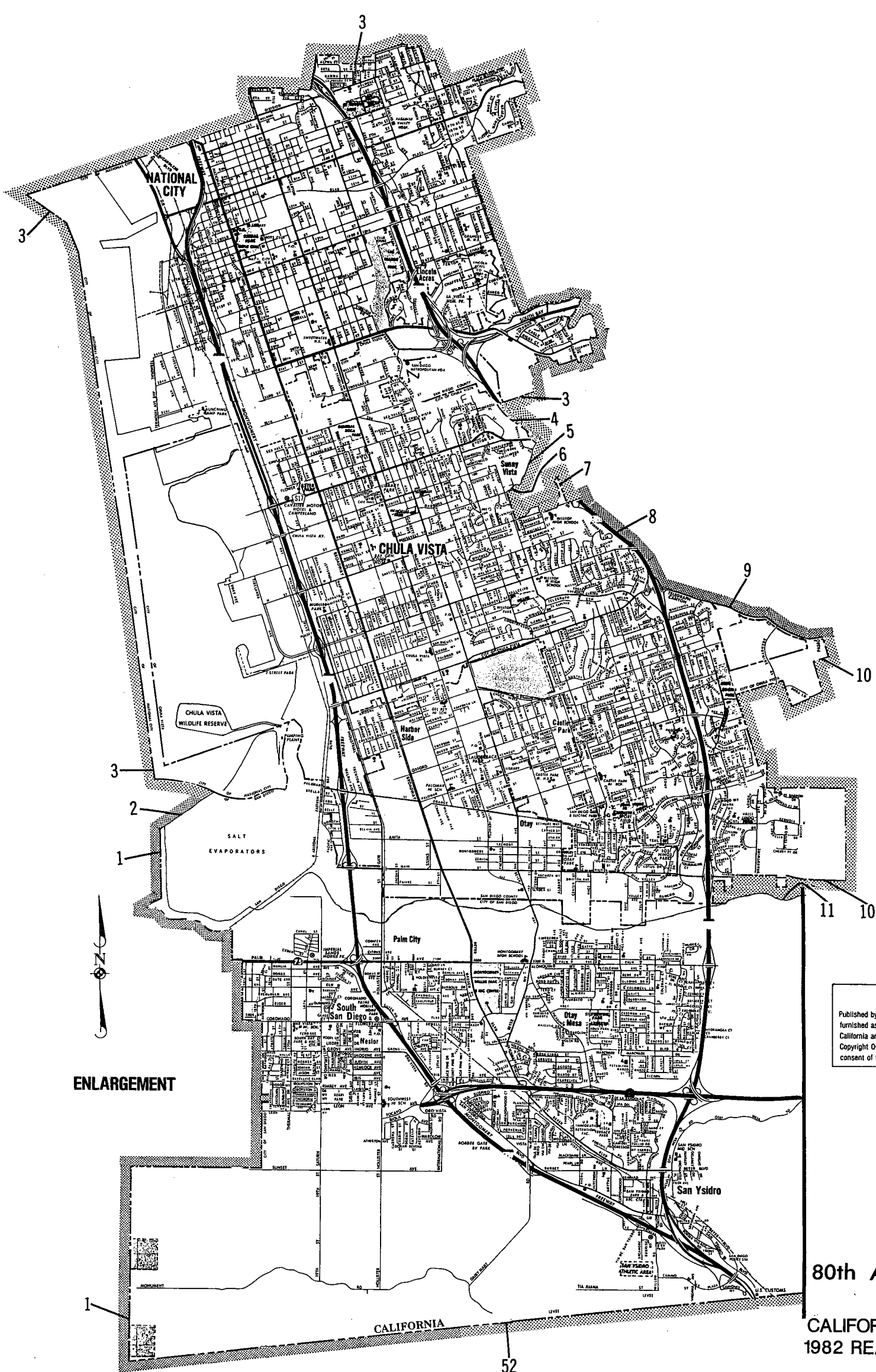

- INDEX OF BOUNDARIES
- 1. San Diego City Limit
 - 2. Boundary between CT 99.02 and CT 101.03
 - 3. National City City Limit
 - 4. Chula Vista City Limit
 - 5. Vista Drive
 - 6. Pepper Tree Road
 - 7. Chula Vista City Limit
 - 8. Interstate 805
 - 9. Telegraph Canyon Road
 - 10. Chula Vista City Limit
 - 11. Otay River
 - 52. Mexican Border

FOR OFFICIAL USE ONLY

Published by the California Legislature from Base Map material furnished as a public service by the Automobile Club of Southern California and the California State Automobile Association. Copyright Owners. Reproduction of this map is prohibited without consent of the copyright owner.

ENLARGEMENT

80th ASSEMBLY DISTRICT
Sheet 2 of 3

CALIFORNIA STATE ASSEMBLY
1982 REAPPORTIONMENT PLAN

Johan Klehs, Chairman
Assembly Committee on
Elections and Reapportionment

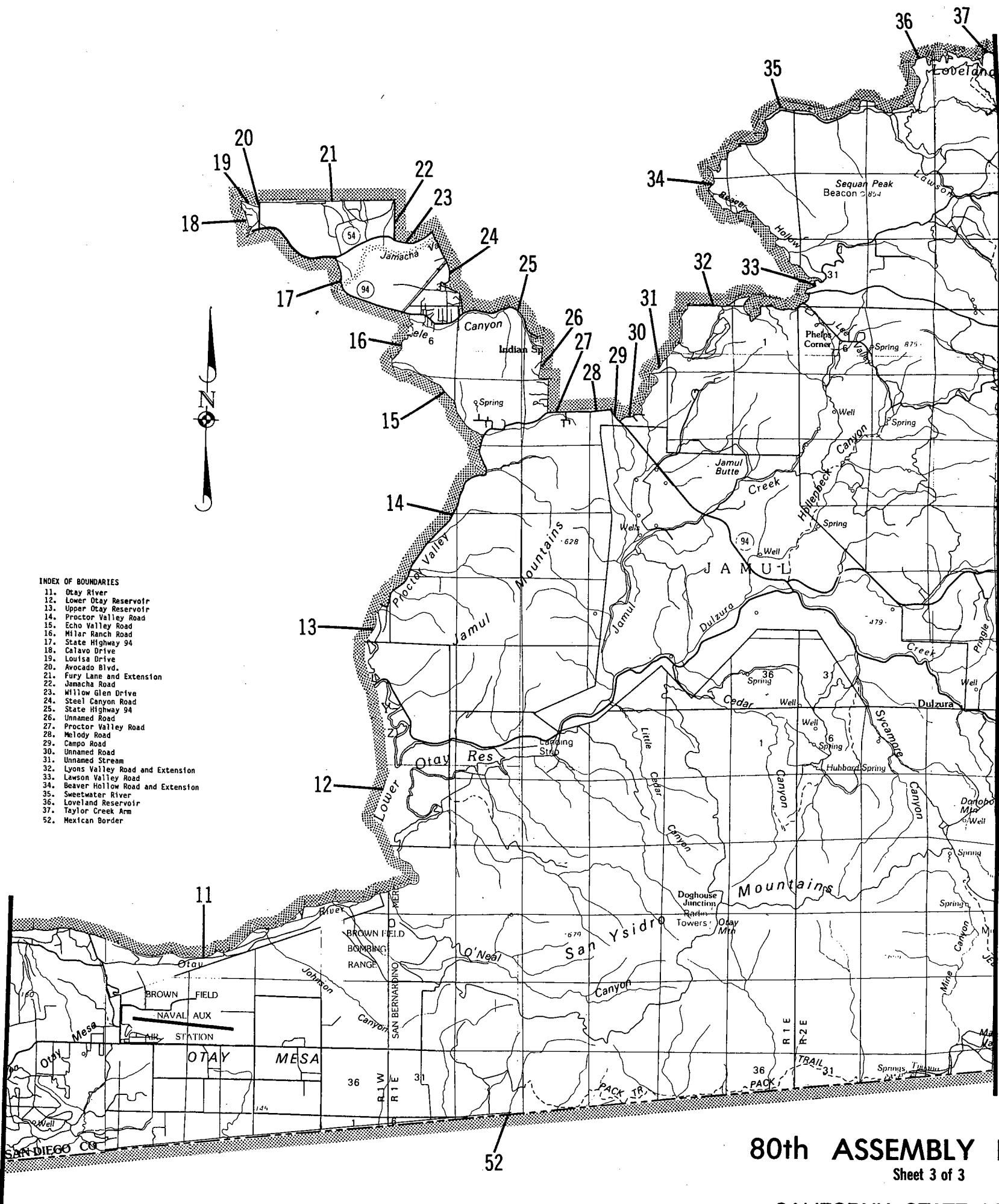

80th ASSEMBLY DISTRICT

Sheet 3 of 3

**CALIFORNIA STATE ASSEMBLY
1982 REAPPORTIONMENT PLAN**

ENLARGEMENT

Johan Klehs, Chairman
Assembly Committee on
Elections and Reapportionment